

PARTNER DISPLAY™

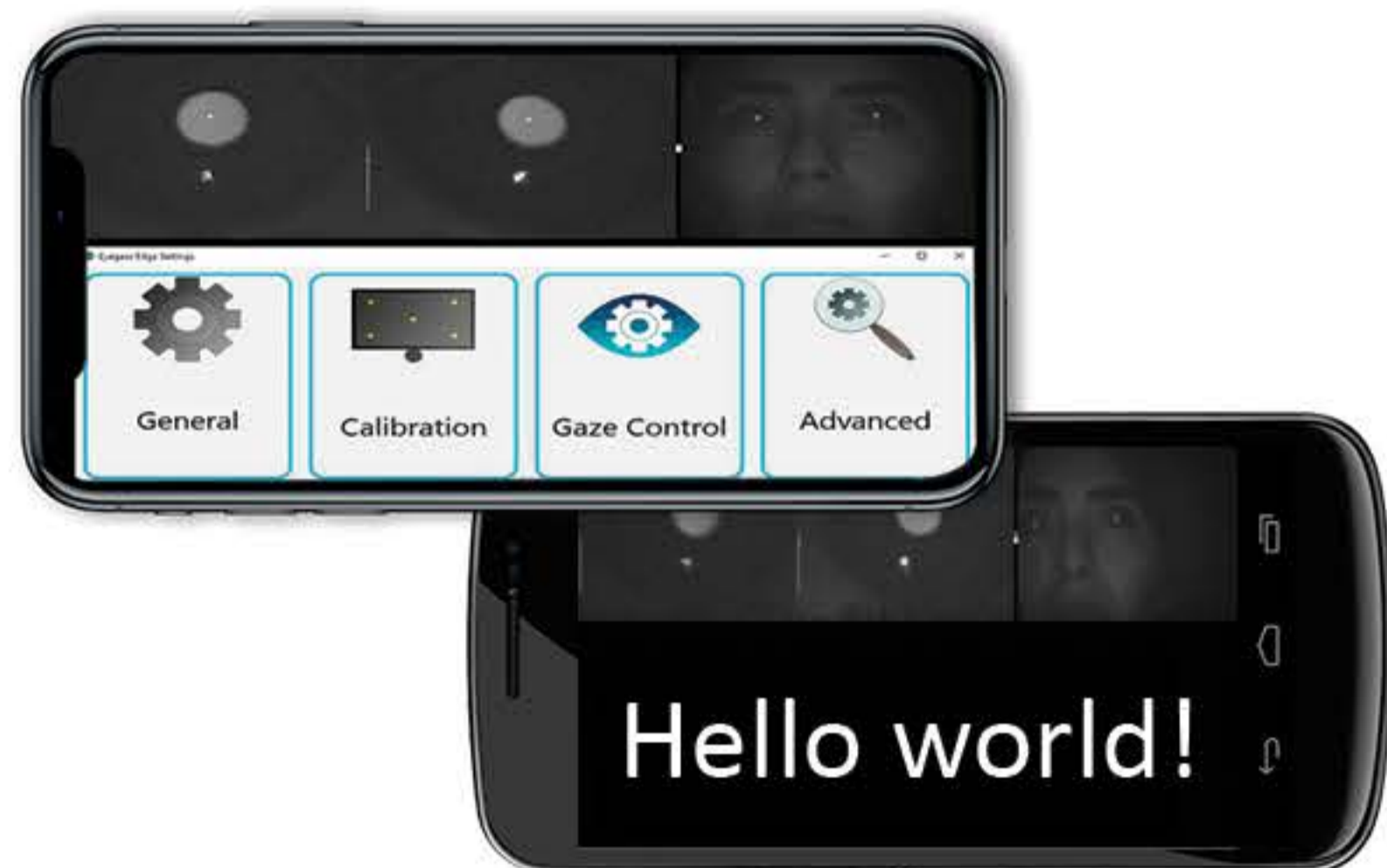

Provided via a hand-held secondary screen on an Apple or Android phone or tablet, the Eyegaze Edge® Partner Display™ changes the way we think about ease of access and communication.

There are three valuable new abilities provided by the Partner Display™:

- A secondary detachable display
- Easy positioning and setup
- Full control of most system settings

When someone communicates via typed text using the Eyegaze Edge®, the text is displayed on the Partner Display™ where it can be positioned to be comfortably viewed. With the Partner Display™, it's easy to communicate even without verbalizing out loud. Chat text, Phrases text, and keyboard text all appear clearly on both the Eyegaze Edge® screen and on the Partner Display™.



Any time you're using an eye tracking system, it's good to be able to see visually how well the system is working. The Eyegaze Edge® has always provided detailed images with added information to show exactly how well it's working. Until now, the eye images have always been on the main display. Sometimes a care giver wants to be able to see those eye images, but might not be able to easily see them depending on how the device is positioned for the user. Now the detailed images are available on the Partner Display™ where a caregiver can easily monitor the system or help position the user to make sure it's easy to run the system.

Our simple but powerful Settings Program is available on the Partner Display™, and changes made take effect immediately. Now a caregiver is able to help adjust and control the Eyegaze Edge® tablet without taking the screen away from the active user. In 2020, we released our new Eyegaze Edge® Settings program that brings all of the system settings and adjustments together in one simple, informative, and easy to use place. With the Partner Display™, we're bringing that usability improvement to the second display device.